

Building Sketch

Borrower/Client	May			
Property Address	1268 South Watermark Avenue			
City	Eagle	County Ada	State ID	Zip Code 83616-6337
Lender	Wells Fargo, N.N. - 035465			

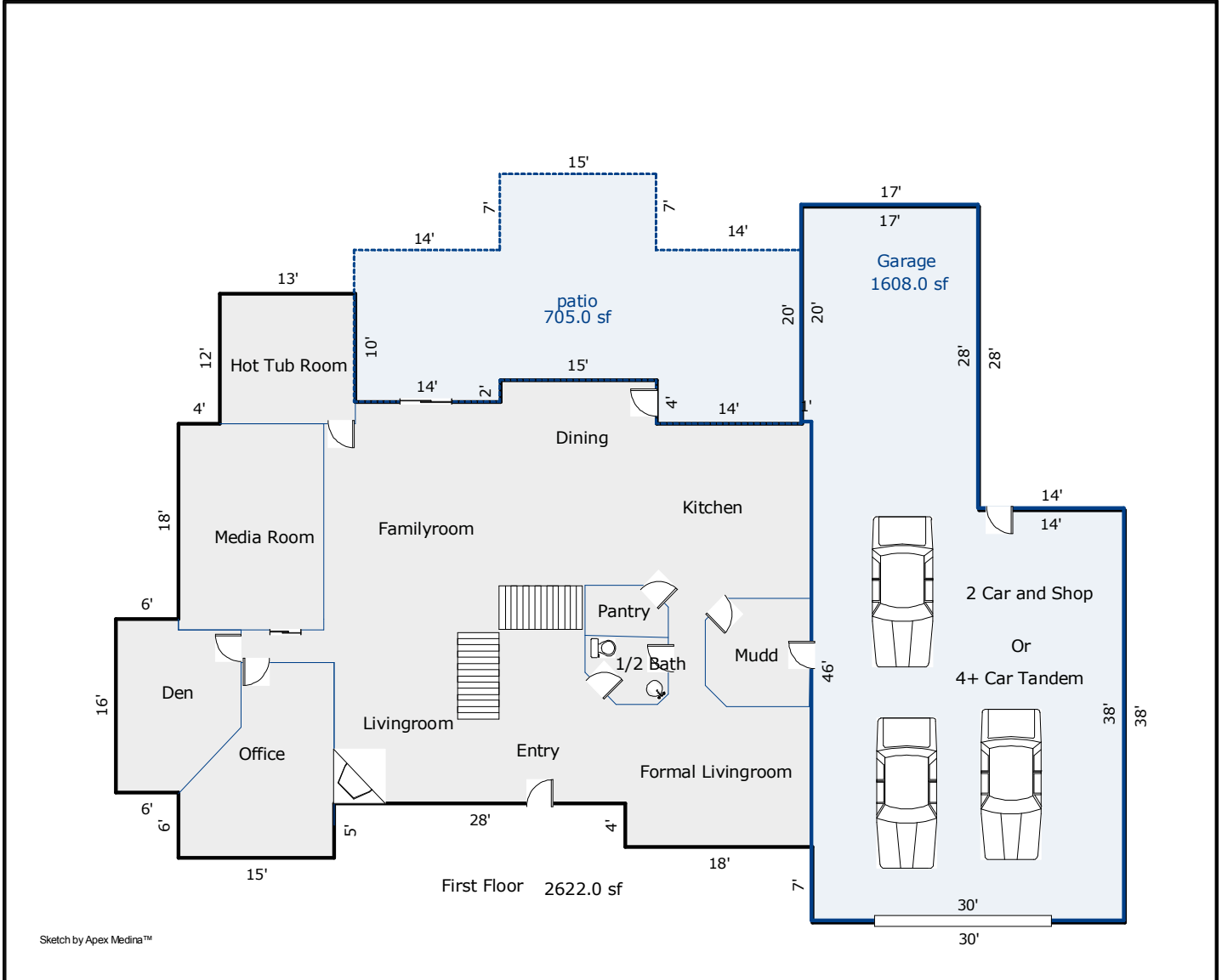

Comments:

AREA CALCULATIONS SUMMARY			
Code	Description	Net Size	Net Totals
GLA1	First Floor	2622.0	2622.0
GAR	Garage	1608.0	1608.0
P/P	patio	705.0	705.0
Net LIVABLE Area		(rounded)	2622

LIVING AREA BREAKDOWN			
Breakdown			Subtotals
First Floor			
30.0	x	7.0	210.0
48.0	x	4.0	192.0
91.0	x	1.0	91.0
5.0	x	15.0	75.0
97.0	x	16.0	1552.0
10.0	x	91.0	910.0
2.0	x	42.0	84.0
20.0	x	17.0	340.0
8.0	x	77.0	616.0
10.0	x	13.0	130.0
2.0	x	15.0	30.0
Garage			-1608.0
11 Items			(rounded) 2622

Building Sketch

Borrower/Client	May			
Property Address	1268 South Watermark Avenue			
City	Eagle	County Ada	State ID	Zip Code 83616-6337
Lender	Wells Fargo, N.N. - 035465			

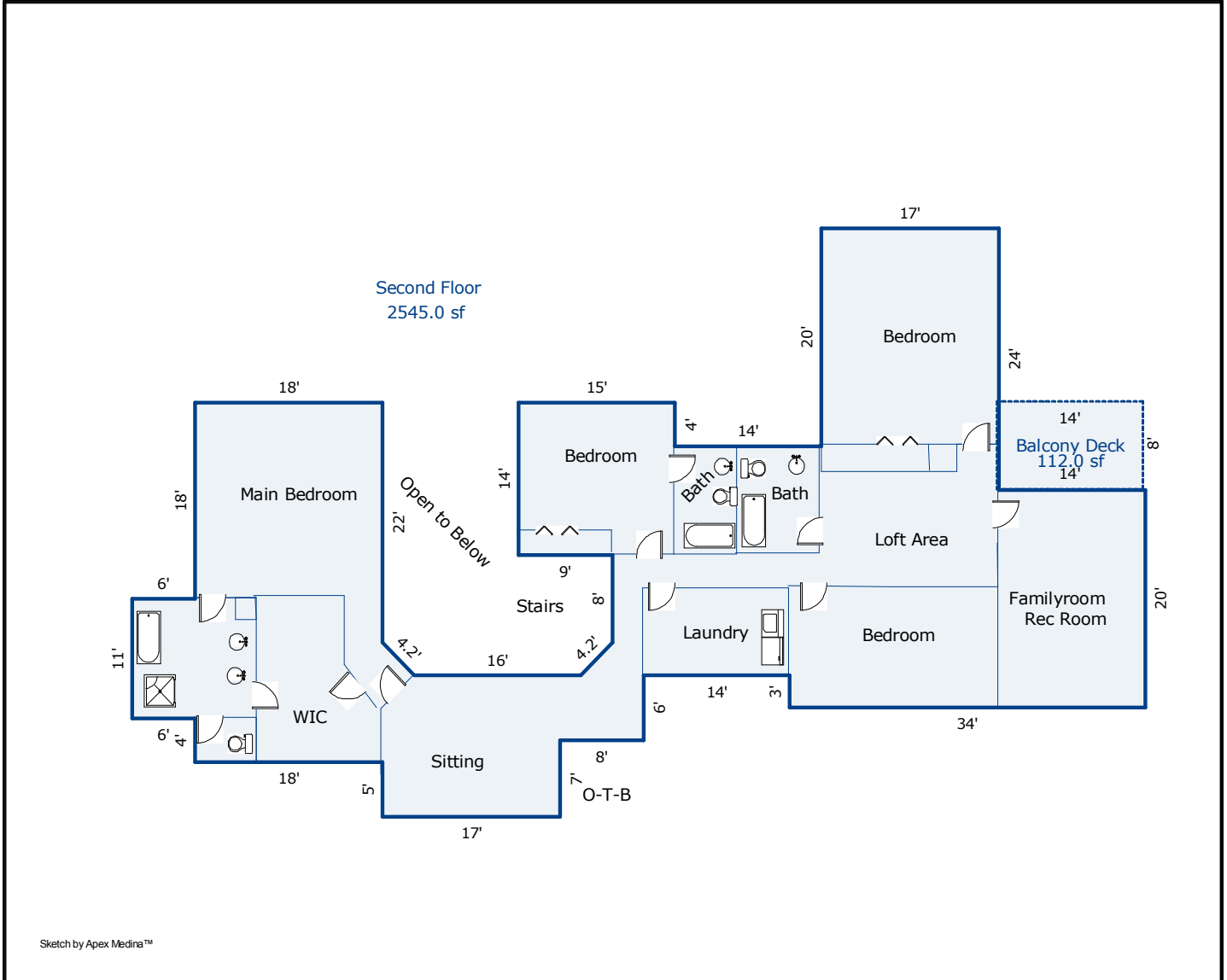

Comments:

AREA CALCULATIONS SUMMARY			
Code	Description	Net Size	Net Totals
GLA2	Second Floor	2545.0	2545.0
P/P	Balcony Deck	112.0	112.0
Net LIVABLE Area		(rounded)	2545

LIVING AREA BREAKDOWN			
Breakdown			Subtotals
Second Floor			
18.0	x	18.0	324.0
7.0	x	24.0	168.0
49.0	x	4.0	196.0
0.5	x	3.0	4.5
0.5	x	3.0	4.5
2.0	x	35.0	70.0
2.0	x	43.0	86.0
3.0	x	34.0	102.0
11.0	x	51.0	561.0
5.0	x	17.0	85.0
60.0	x	6.0	360.0
4.0	x	15.0	60.0
20.0	x	17.0	340.0
4.0	x	46.0	184.0
14 Items			(rounded) 2545